

**Skill Level: 5 out of 10
Mechanical Ability Needed**

DMR/Honda Kit-Blade Installation

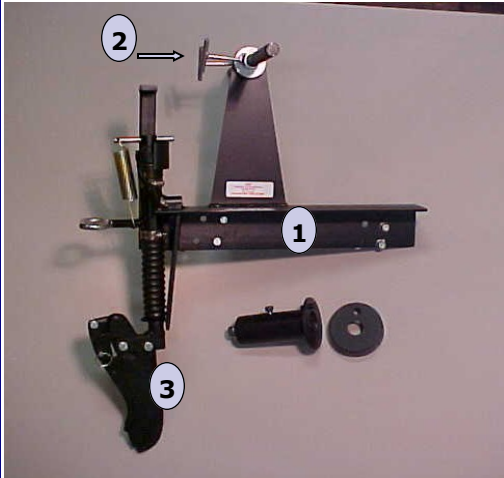
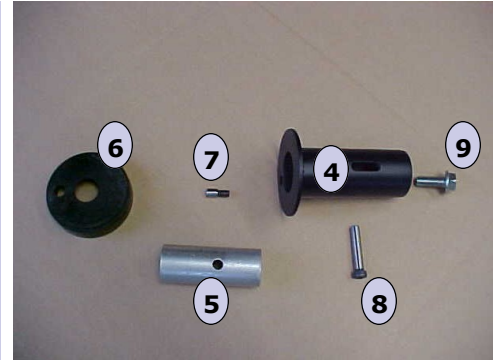

Diagram:

- 1 Main Bracket
- 2 Wire Spool Clutches
- 3 Wire Feeder
- 4 Blade Holder Outer Sleeve
- 5 Blade Holder Inner Sleeve
- 6 Cutting Blade Cup
- 7 Blade Pin
- 8 Blade Holder Pin
- 9 Blade Holder Bolt



**Tools: Socket-Impact Wrench
12mm, 1/2", 9/16", and 3/4"**

Main Bracket Attachment:

Initial Installation with Kit shipped separate from tiller: Remove Red Honda Deck and Tiller Tines, exposing axle. Save (2) mounting bolts from the front of the deck. You'll need these to attach the Main Bracket.

The Main Bracket (*part #1*) is attached to the right side of the tiller (while standing behind the handlebars). There are four holes on the bracket. The kit is shipped with the DMR supplied hardware attached.

Attach the Wire Feeder (*part #3*) onto the base of the piston (use 9/16" socket) using the two DMR supplied nuts and bolts (Feeder comes attached when shipped with trencher).

Screw in the left spool bar to the top of the main bracket.

Slide spool(s) of wire on to the spool bar(s). Place the Wire Spool Clutches (*part #2*) on the spool bar, putting a slight bit of pressure on the spring while tightening the screw "T" handle. Clutch should fit snug, but not so tight as to prevent the wire spool from spinning.



99 Main Street
Brewster, NY 10509

Custom Trenchers
Since 1990

Phone: 800-838-9909
Local: 845-279-8648
E-mail: dmrdog2@comcast.net
Web: www.dogfencetrencher.com

Cutting Blade Installation: Place the Cutting Blade Cup (*part #6*) on the axle (where the tiller tines were removed). Place the cutting blade on the axle next. Line up the holes in the cup and blade.

Place the Blade Holder (*part #'s 4,5,7 & 9*) on the axle. **Inner and Outer Sleeve come pre-assembled** with Blade Holder Bolt and Pin. Align the holes in the Blade Holder with the outer hole on the axle. Drop the Blade Holder Pin (*part #8*) through the hole completely.

Using an impact wrench, fully torque the Blade Holder Bolt (*part#9*), or use hand tools and exert maximum pressure.

Tooth Direction: Reverse Mechanism Installed (Axle spins opposite direction as wheels)- Teeth point *counter-clockwise*. Without reverse drive: Factory Forward Drive-Teeth point *clockwise* (facing tiller from right side).

Cutting Blade Replacement:

Loosen Blade Holder Bolt 1 1/2 turns, pulling the Blade Holder Pin out before removal. Do not fully remove the Blade Holder Bolt.

Note: DMR Ugly Blades are bi-directional, to maximize usage, flip cutting blade when you begin to

Questions or need technical help? Don't hesitate to call 800-838-9909

We stock Honda
Replacement Parts
below list price
Overnight shipping



99 Main Street
Brewster, NY 10509

Phone: 800-838-9909
Local: 845-279-8648
E-mail: dmrdog2@comcast.net
Web: www.dogfencetrencher.com